

# LaHabra® Acrylic Primer



LaHabra® Acrylic Primer is a 100% acrylic-based primer which provides a flat, uniformly absorbent, color-matched surface for application of LaHabra's Acrylic or Elastomeric Finish.

LaHabra Acrylic Primer is recommended for the surface preparation of stucco, concrete, masonry and drywall to improve the coverage and performance of LaHabra Acrylic or LaHabra Elastomeric Finishes.

## LaHabra Advantages

- ❑ Reduces the chance of efflorescence, which may result from the cement content of plaster bases.
- ❑ Improves finish coverage.
- ❑ Enhances uniformity and appearance of the finish.
- ❑ Is water vapor permeable. Does not create a vapor barrier.
- ❑ Improves water resistance of LaHabra plasters.

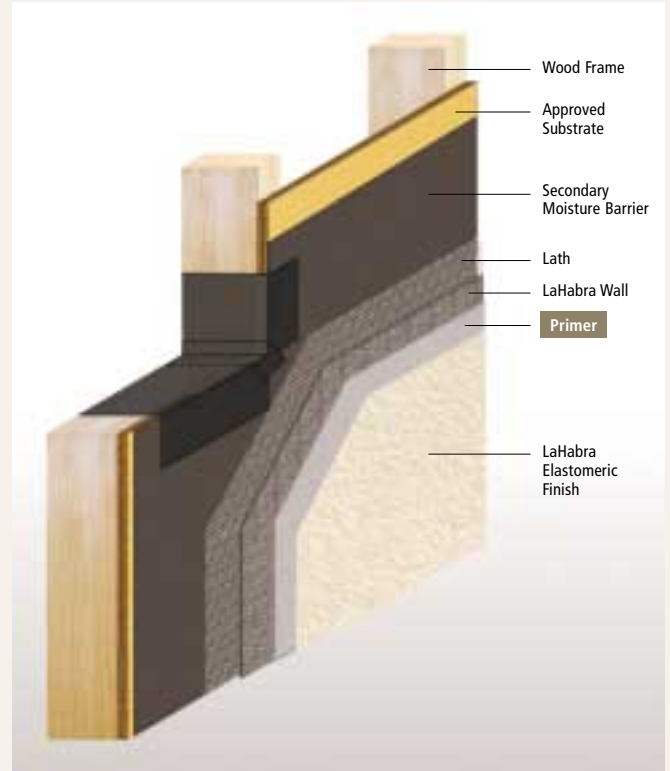

# LaHabra

# LaHabra® Acrylic Primer

## Architectural Specification Guide



### Description

LaHabra® Acrylic Primer is a 100% acrylic-based primer which provides a flat, uniformly absorbent, color-matched surface for application of LaHabra's Acrylic or Elastomeric Finish.

LaHabra Acrylic Primer is recommended for the surface preparation of stucco, concrete, masonry and drywall to improve the coverage and performance of LaHabra Acrylic or LaHabra Elastomeric Finishes.

### LaHabra Advantages

- Reduces the chance of efflorescence, which may result from the cement content of plaster bases.
- Improves finish coverage.
- Enhances uniformity and appearance of the finish.
- Is water vapor permeable. Does not create a vapor barrier.
- Improves water resistance of LaHabra plasters.

### Composition

- A. Binder base: 100 percent acrylic.
- B. Water-based: VOC compliant.
- C. Pigment base: Titanium dioxide.
- D. Color: White, or tinted to the color of the LaHabra finish.

### Packaging

LaHabra Acrylic Primer is available in 60 lb. (27.7 kg) net weight 5 gal. (18.9L) plastic pails.

### Storage

LaHabra Acrylic Primer must be stored at 40°F/4°C or above in tightly sealed containers and out of direct sunlight. Shelf life: One year if protected from sun and frost.

### Coverage

One coat: 1600-2000 sq. ft. (150-185 sq. m.) per pail, approximately, depending on the method of application and surface to which it is applied.

### Job Procedure

- A. Condition of Base:
  - 1. Surfaces must be clean, dry, structurally sound and free of efflorescence, grease, oil, form release agents and curing compounds.
  - 2. For additional options for surface preparation, contact LaHabra Technical Services Department.
- B. Mixing:
  - 1. Mix thoroughly. Up to 2 gallons (7.5L) of clean potable water can be added.
  - 2. Avoid creating air bubbles or foam.
- C. Application:
  - 1. Apply with a roller, brush or suitable spray equipment in a continuous coat.
  - 2. LaHabra Acrylic Primer must completely dry before any LaHabra finish is applied.
- D. Drying Time: The drying time of LaHabra Acrylic Primer is dependent upon the air temperature and relative humidity. Under average conditions (70°F/21°C, 55% R.H.), LaHabra Acrylic Primer is dry to the touch in 1/2 hour and sufficiently dry for application of finish in 2 hours. Protect from rain for at least 4 hours.
- E. Cleanup: Water soluble prior to drying. Clean tools and containers with water prior to drying.

### Cautions and Limitations

- A. Ambient and surface temperatures must be 40°F (4°C) or above during application and drying time. Supplemental heat and protection from precipitation must be provided as needed.
- B. Use only on surfaces that are sound, clean, dry, and free from any residue which may affect the ability of the LaHabra Acrylic Primer to bond to the surface.
- G. See package for handling precautions.
- H. Always wear proper safety equipment, including particle mask, when mixing and/or applying this product.

*Information contained herein conforms to general recommendations for the installation of LaHabra Acrylic finish, and is provided in good faith. LaHabra Products, Inc. assumes no liability, expressed or implied, as to the workmanship, engineering or architecture of any project.*



### Corporate Office

**ParexLaHabra, Inc.**  
4125 E. La Palma, Suite 250  
Anaheim, CA 92807  
Phone: 1-877-LHSTUCCO  
Fax: 714-774-2079  
**Email: info@lahabrastucco.com**  
**lahabrastucco.com**

### Sales Offices & Warehouses

**Anaheim**  
P.O. Box 3700  
1631 W. Lincoln Ave.  
Anaheim, CA 92803  
Phone: 714-774-1186  
Fax: 714-774-8599

**North Hollywood**  
8161 Lankershim Blvd.  
North Hollywood, CA  
91605-1611  
Phone: 818-504-9180  
Fax: 818-504-1985

**Northern California**  
11290 South Vallejo Court  
French Camp, CA 95231  
Phone: 209-983-8808  
Fax: 209-983-8873

**Riverside**  
2150 Eastridge Ave.  
Riverside, CA 92507  
Phone: 951-653-3549  
Fax: 951-653-8189

**Dallas**  
Warehouse  
P.O. Box 188  
Cresson, TX 76035  
Phone: 972-820-8258  
Fax: 972-467-5836  
*Customer Service*  
Phone: 1-877-LHSTUCCO  
Fax: 714-774-8599

